

DETALHE - CAIXA de INSPEÇÃO  
esc.:1/25

DETALHE - CAIXA de AREIA  
esc.:1/25

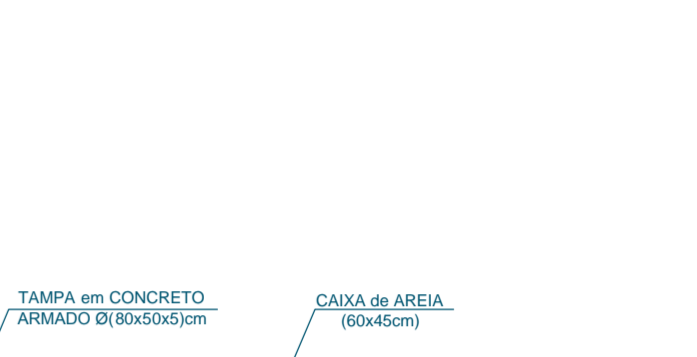
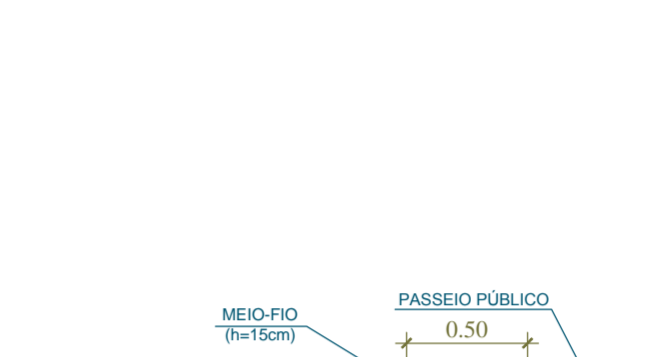
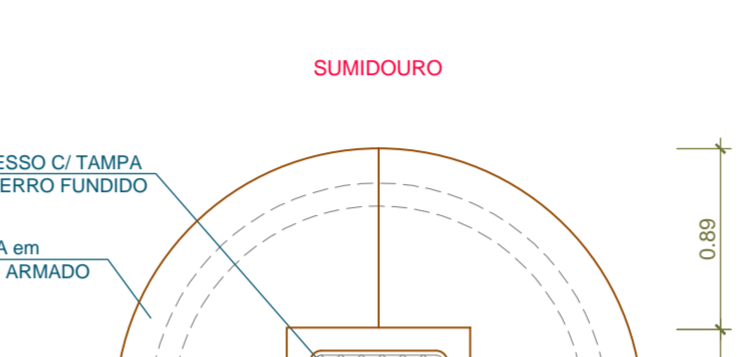
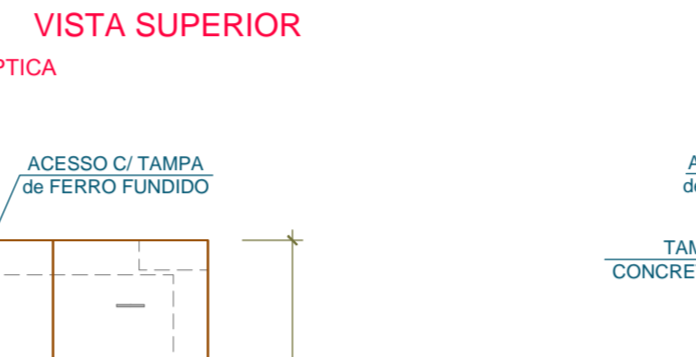
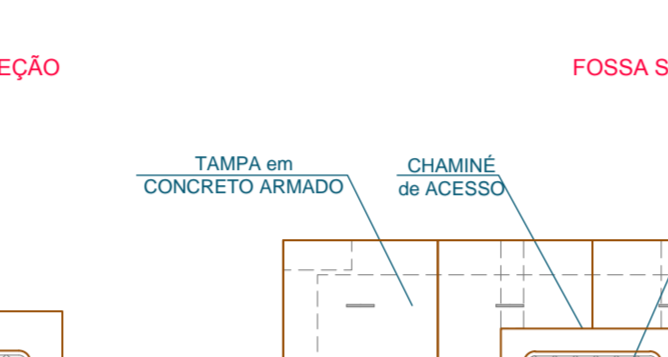
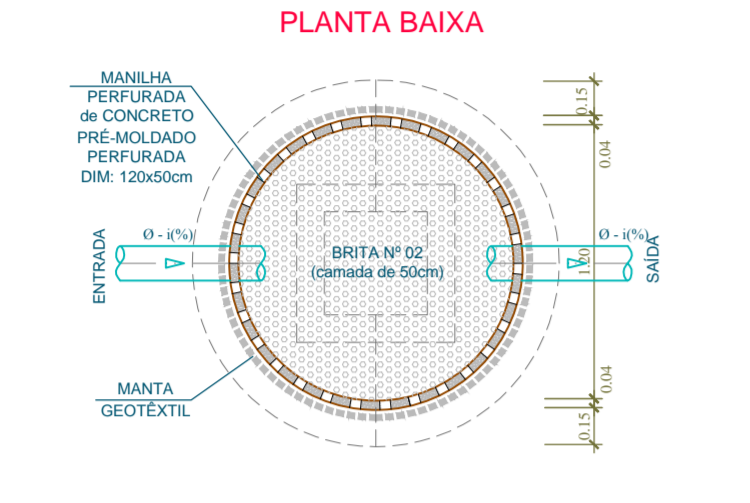

DETALHE - CAIXA de INSPEÇÃO  
esc.:1/25

DETALHE - CANALETA SOB PASSEIO PÚBLICO  
sem esc.

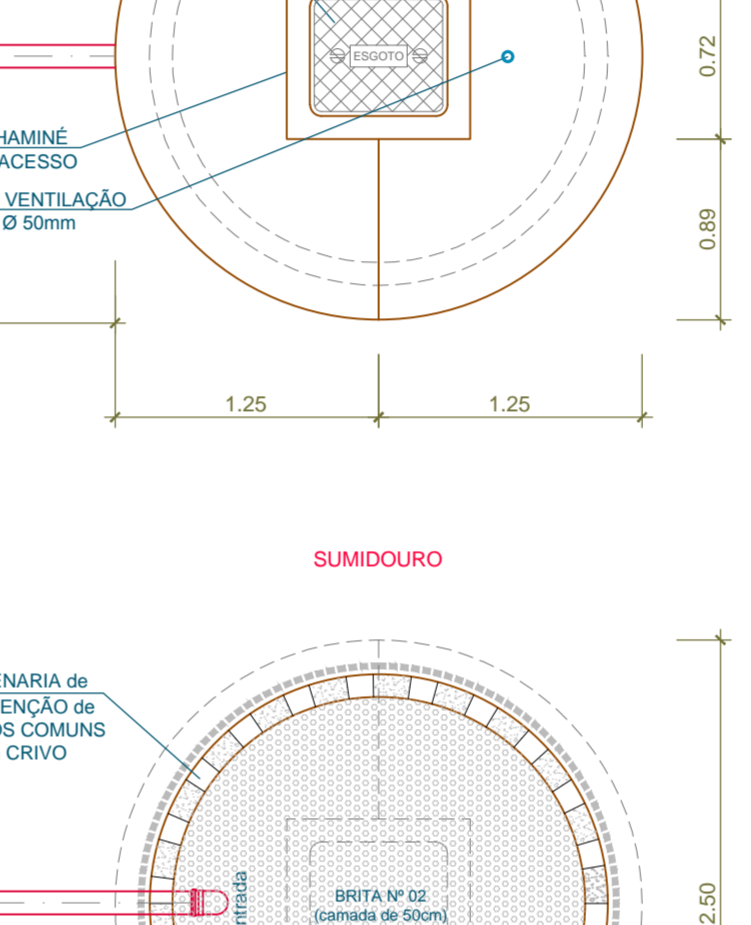
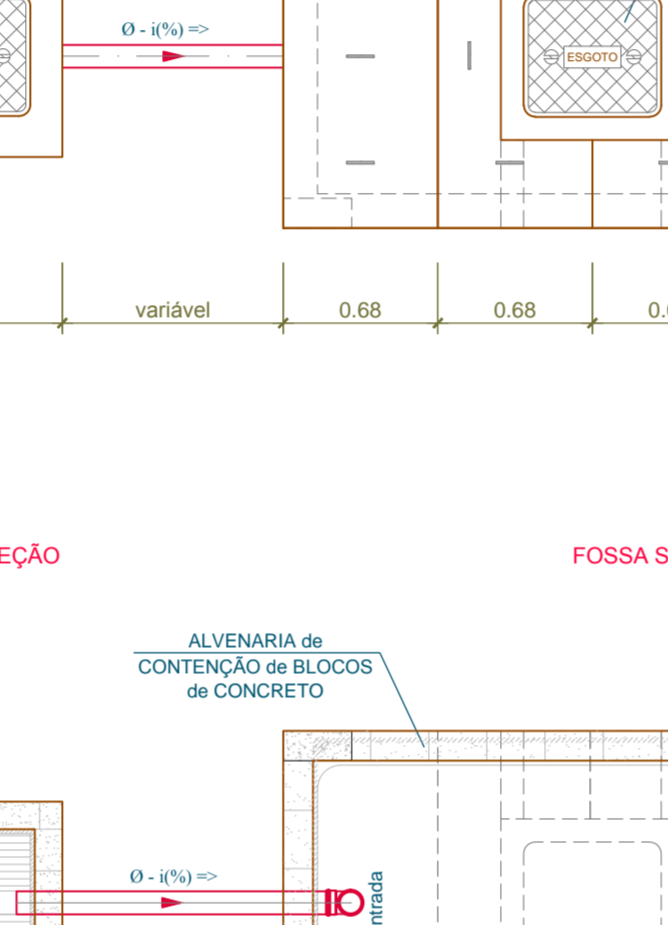
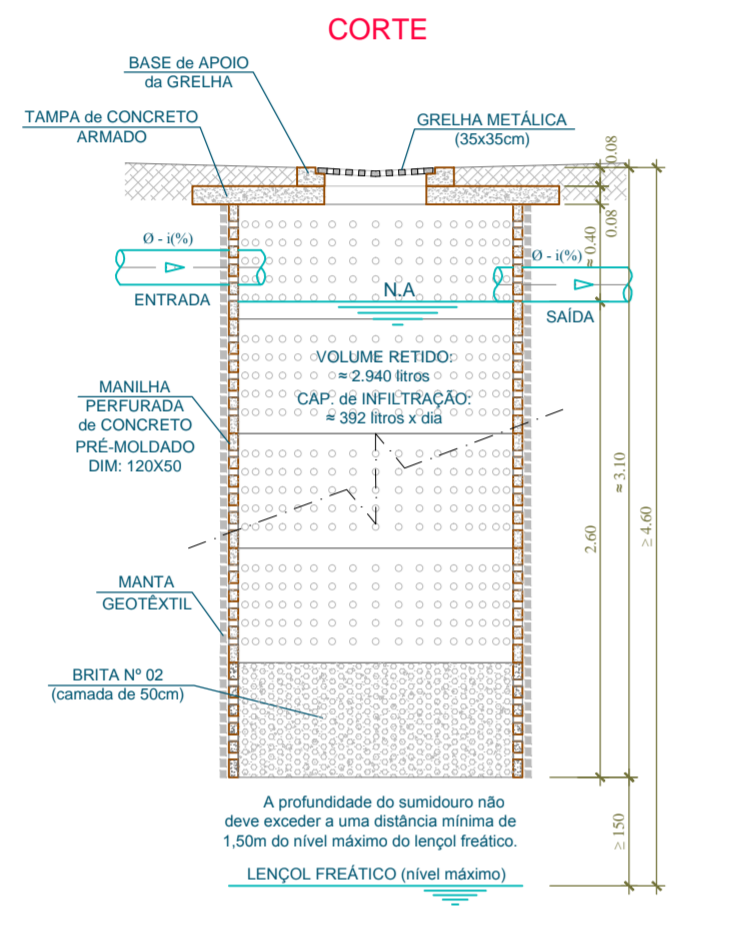

DETALHE - POÇO de INFILTRAÇÃO  
esc.: 1/33

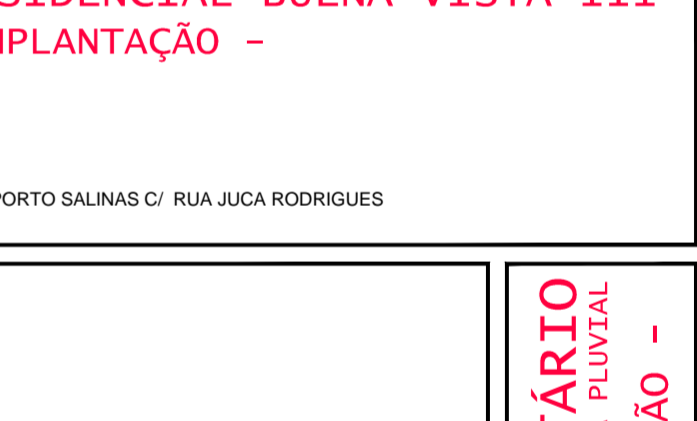
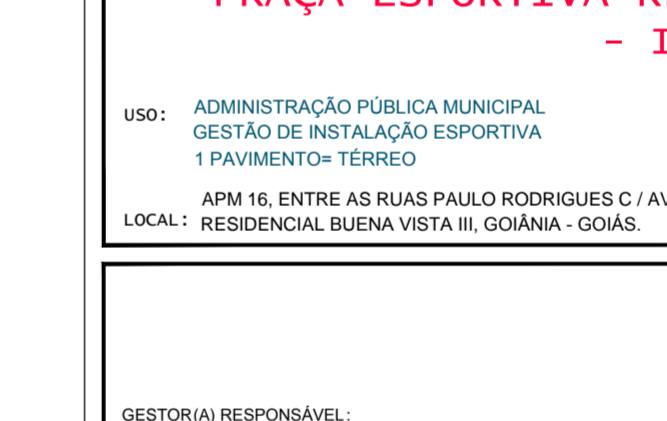
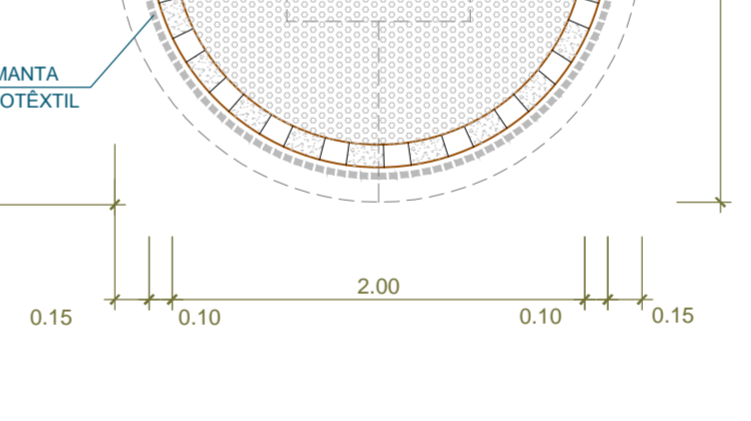
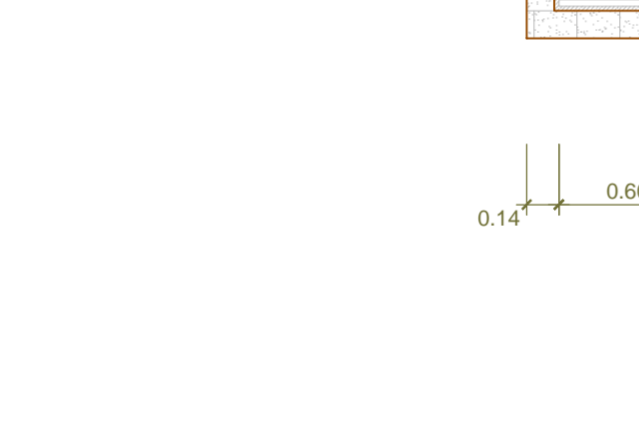
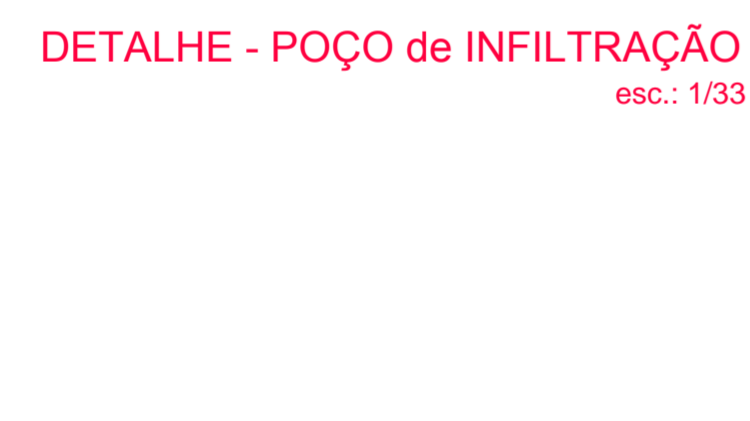

DETALHE - TANQUE SÉPTICO e SUMIDOURO(S)  
esc.: 1/33

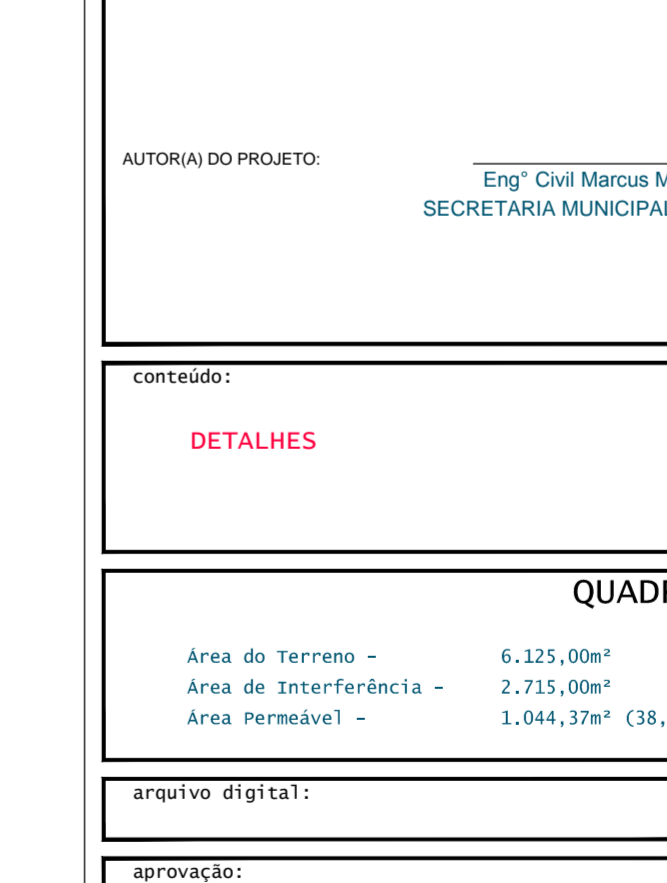
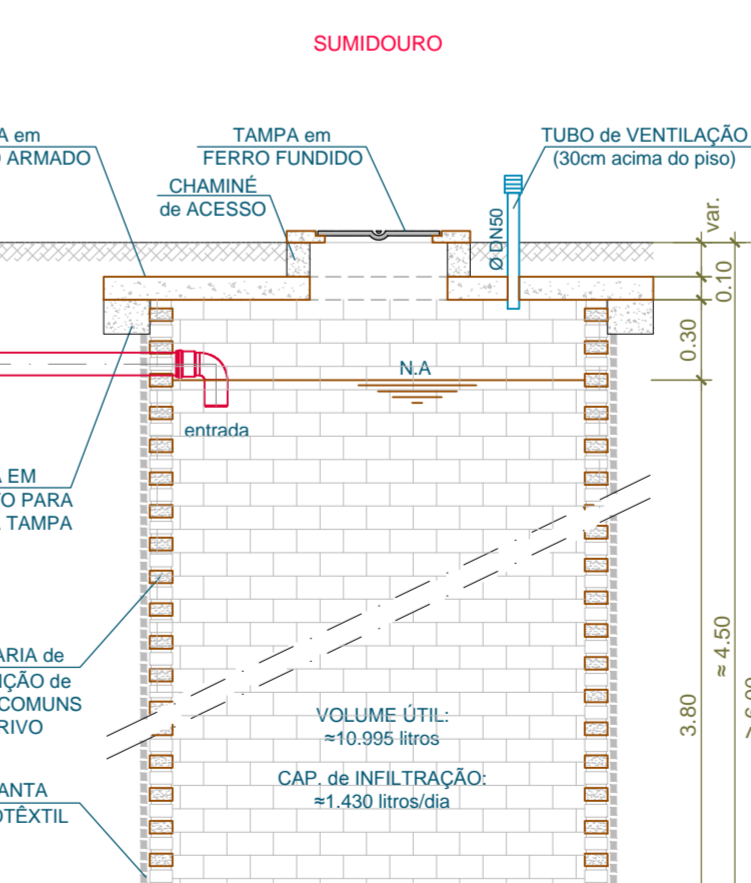
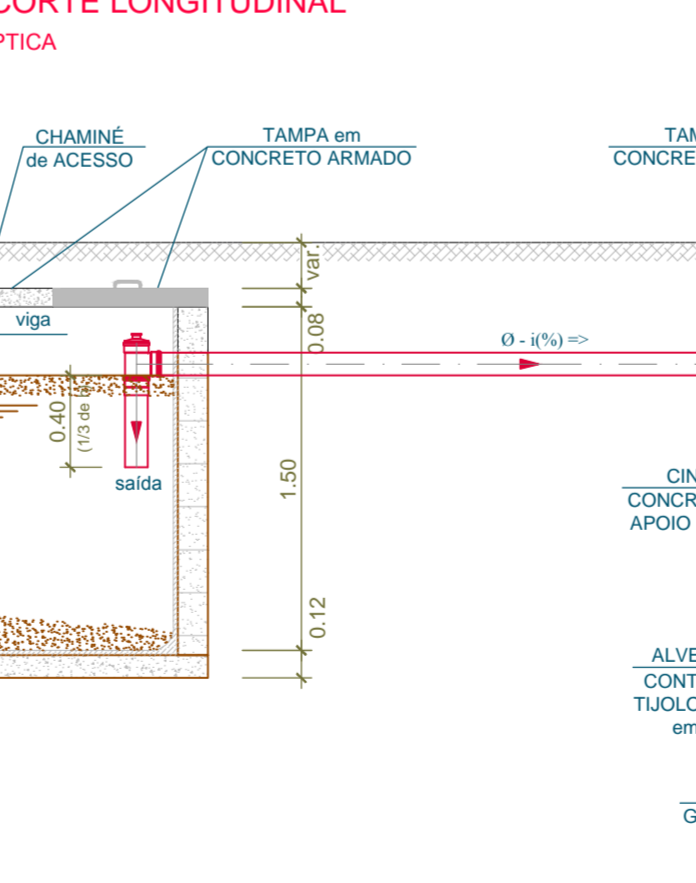
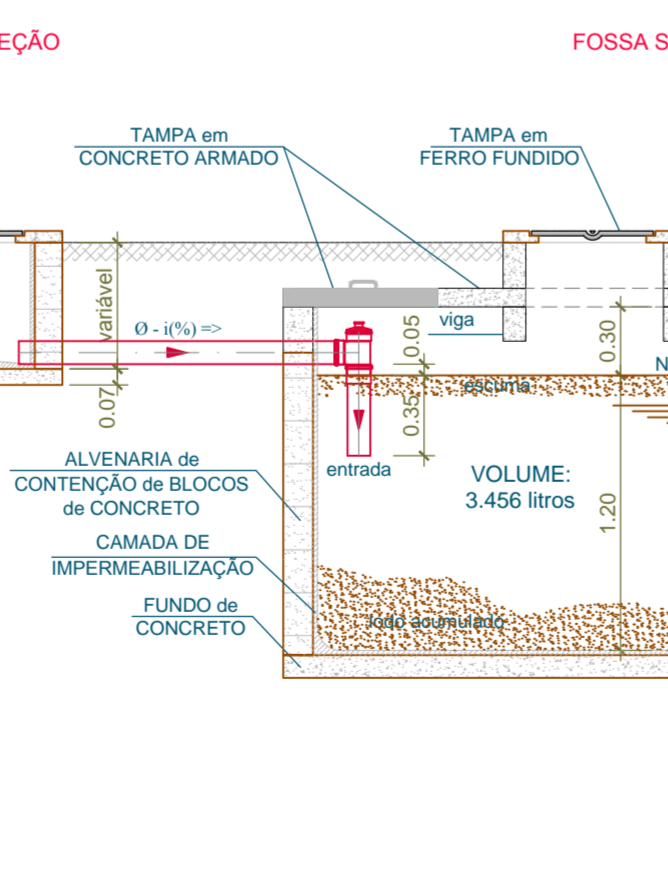
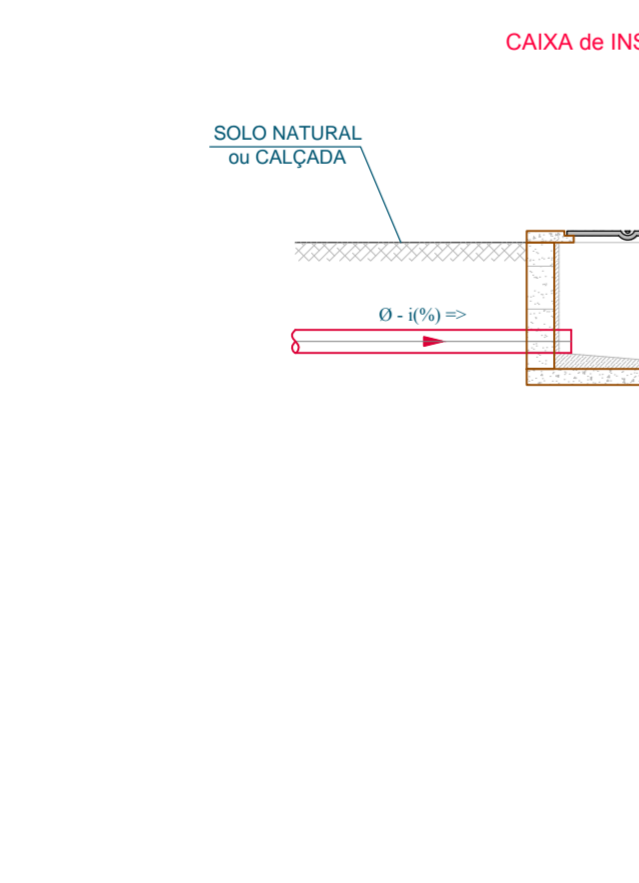
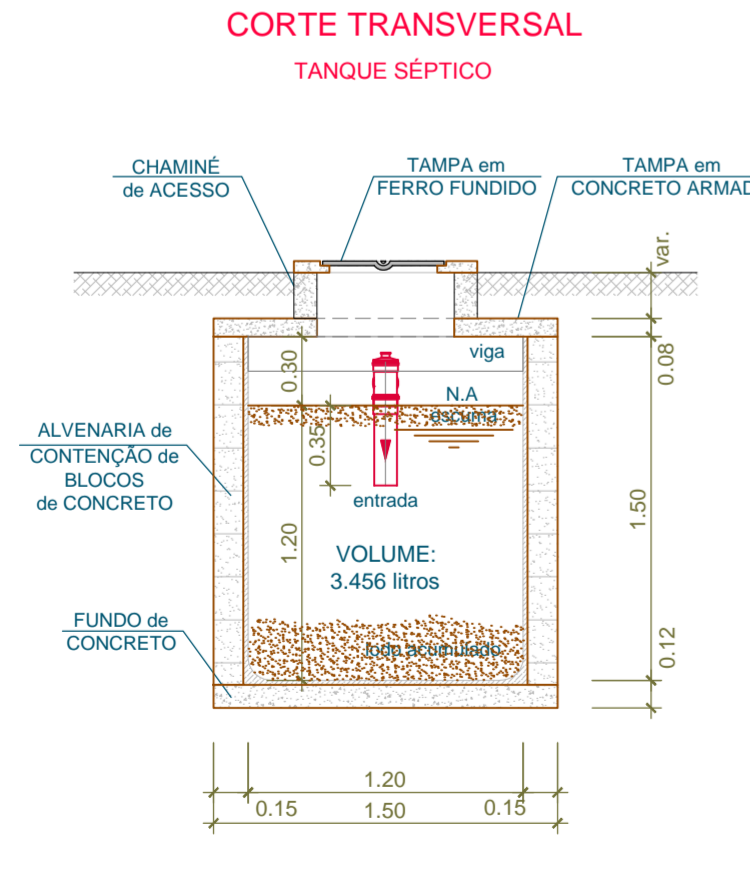

**PREFEITURA MUNICIPAL DE GOIÂNIA**  
SECRETARIA MUNICIPAL DE INFRAESTRUTURA E SERVIÇOS PÚBLICOS - SEINFRA  
DIRETORIA DE POLÍTICAS E PROGRAMAÇÃO DE OBRAS PÚBLICAS  
GERÊNCIA DE ESTUDOS E PROJETOS

---

**OBRA: PRAÇA ESPORTIVA RESIDENCIAL BUENA VISTA III - IMPLANTAÇÃO -**

USO: ADMINISTRAÇÃO PÚBLICA MUNICIPAL  
GESTÃO DE INSTALAÇÃO ESPORTIVA  
1 PAVIMENTO+ TERREO

APM 16, ENTRE AS RUAS PAULO RODRIGUES C / AV. PORTO SALINAS C / RUA JUCA RODRIGUES  
LOCAL: RESIDENCIAL BUENA VISTA III, GOIÂNIA - GOIÁS.

---

GESTOR(A) RESPONSÁVEL: \_\_\_\_\_  
AGÊNCIA MUNICIPAL DE TURISMO, EVENTOS E LAZER

AUTORIA DO PROJETO: \_\_\_\_\_  
Engº Civil Marcus Miranda Magalhães - CREA:14.890/D-GO  
SECRETARIA MUNICIPAL DE INFRAESTRUTURA E SERV. PÚBLICOS - SEINFRA -

---

conteúdo: **DETALHES**

prancha: **2/2**

escala: **Indicada**

---

**QUADRO DE ÁREAS**

Área do Terreno - 6.125,00m²	Área Total a Construir - 881,85m²
Área de Interferência - 2.715,00m²	Construir - Centro de Convivências - 94,35m²
Área Permeável - 1.044,37m² (38,46%)	Construir - Quadra Coberta - 787,50m²

---

arquivo digital: \_\_\_\_\_ num. pav.: 01 desenho: MARCUS M.M. data: OUTUBRO/2016

aprovação: \_\_\_\_\_